

LEE CEMETERY
 ON
 WAUWINET ROAD
 BARRE, MA
 TOWN OF BARRE
 CEMETERY COMMISSION
 HANK CONSULTING, INC.
 3 WEDGEMAN LANE
 MILLBURY, MA 01527
 PHONE: (203) 844-7260
 DATE: 12/10/17
 BY: JRC
 SCALE: 1"=8'

CURRENT CEMETERY
 COMMISSION MEMBERS (2017):
 DAVID RICHARD
 DIANE COOK
 TIMOTHY WOODWARD
 CEMETERY CLERK:
 PAULA M. BARTKUS

NOTE: THE LOCATIONS OF ALL BURIAL
 PLOTS HAVE NOT BEEN COMPLETED.

NOTE: THE INFORMATION SHOWN ON THIS PLAN
 WAS DERIVED FROM AN EXISTING CEMETERY
 PLAN WHICH HAS BEEN SCANNED AND
 PLACED ON A COMPUTER. ANY ERRORS
 ARE CURRENTLY STORED IN THE VAULT OF THE
 TOWN CLERK'S OFFICE.



LOCUS MAP

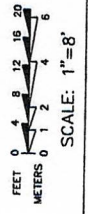
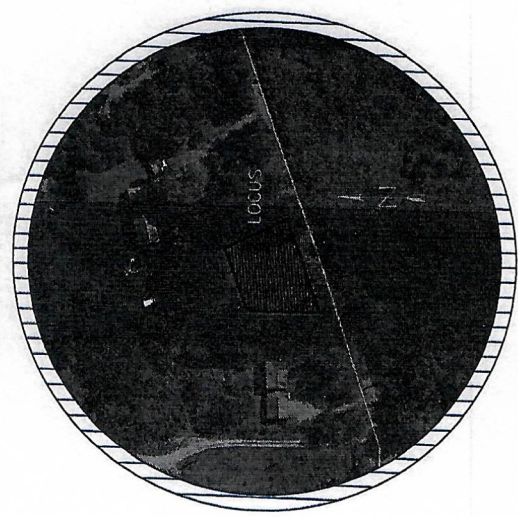

WUWINET ROAD

LEE CEMETERY

ALL

SEC. 7

SEC. 8

SEC. 9

COLE DANIEL
 COLE LOUISA
 COLE CYRUS P.
 COLE JOHN 50

SEC. 4

WALLACE AZUBAH
 WALLACE BEULAH
 WALLACE JOHN

UNKNOWN
 UNKNOWN

SEC. 1

HOLDEN MARTHA
 HOLDEN MARTHA (WADSWORTH)
 HOLDEN JOSIAH D.
 HOLDEN MRS. SARAH
 HOLDEN
 Dea. MOSES

HOLDEN CHARLES S

WLLSWORTH SAMUEL P.
 ELLSWORTH JOHN

SEC. 5

WHITNEY MARY
 HASTINGS WALTER

SEC. 2

BABBITT AVERY
 BABBITT MARY S.
 BABBITT JULIA ANN
 BABBITT JANE
 BABBITT LUTANA
 CALDWELL JOHN 50

ATWOOD
 LUM
 BARNABUS
 GRATEE
 ATWOOD
 BARNABUS
 ATWOOD
 CHLOE
 ATWOOD
 ZACHEUS

SEC. 3

ATWOOD
 GRATEE
 BARNABUS
 ATWOOD
 CHLOE
 ATWOOD
 ZACHEUS

WALL

WAUWINET ROAD

WALL

5/31/2020
 1/9/20
 Cemetery
 Lee Cemetery

LEE CEMETERY

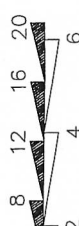
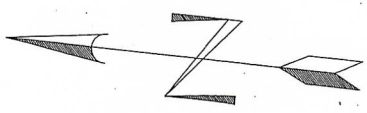

F. 1"=8'